

Digital Cabinets Mega Top Table, 29" with 2 drawers and 9GN1/6+3GN1/9 containers - Stainless Steel (R290)

ITEM # _____
MODEL # _____
NAME # _____
SIS # _____
AIA # _____



738286 (KCHMT29.12.2D)

1-drawer mega top
preparation table, 29", R290
refrigerant gas, +33/+41°F,
stainless steel

Short Form Specification

Item No.

2-drawer mega top refrigerated preparation table. Exterior back panel in aluminium, exterior bottom panel in galvanized steel, exterior side and top panel in 430 stainless steel; interior back and top panels in painted aluminium, interior bottom panel in 304 stainless steel, worktop in 430 stainless steel.

Built-in refrigeration unit and an insulated lid to maintain food freshness. Fin & Tube Condenser improves performance in high-temperature environments. Automatic Defrost Cooling System to provide worry-free performances.

Full-depth cutting board of 79x70x8 in.

Digital control panel, Vinyl-Coated Steel adjustable shelves, removable door gaskets and self-closing doors with 90-degree stay-open feature.

Temperature range: +33/+41°F.

R290 gas in the refrigeration circuit.

ETL Safety and Sanitation certifications.

3/5 Years warranty.

Main Features

- Removable door gasket for easy cleaning operations.
- Hydrocarbon refrigerant gas R290 for the lowest environmental impact (GWP=3) - CFC and HCFC free.
- Fin & Tube Condenser improves performance in high temperature environments.
- Automatic Defrost Cooling System provides worry-free performance.
- Electronic Digital Temperature Control, quick and simple to set, with control display for easy monitoring.
- Full Depth cutting board.
- External temperature display.
- High efficiency components to minimize the energy consumption still guaranteeing the highest performances.
- Cabinet and door insulated with high density polyurethane for low environmental impact.
- Heavy duty Vinyl coated steel shelves.

Construction

- Self-closing door with 90-degree stay-open feature.
- Heavy duty casters.
- Insulated lid maintains food freshness.
- Pre-wired heavy duty power cord.
- Heavy duty door hinges.
- Magnetic door gasket removable without tools for easy cleaning.

APPROVAL: _____

Front

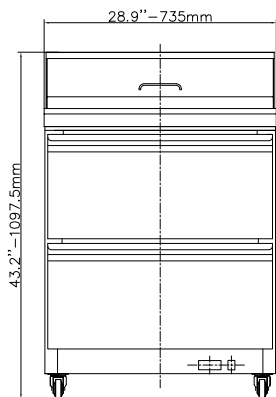

Side

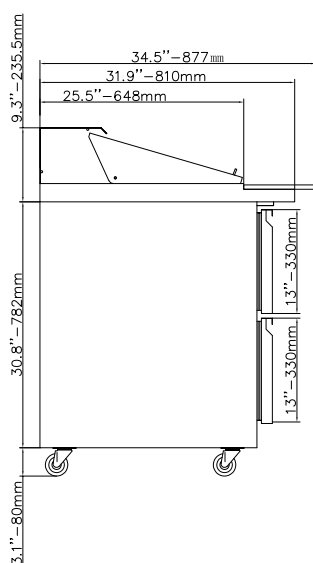

EI = Electrical connection
RI = Refrigerant Inlet
RO = Refrigerant Outlet

Top

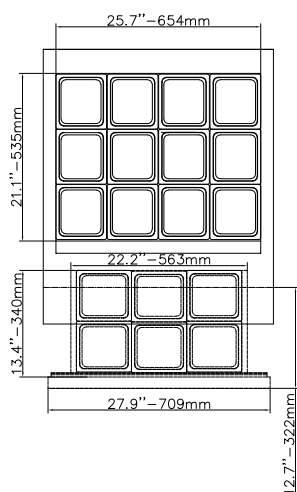

Electric

Supply voltage:

738286 (KCHMT29.12.2D) 115 V/1 ph/60 Hz

Electrical power, max:

517.5 kW

Plug type:

USA NEMA 5-15P

Key Information:

Gross capacity:

198.22 lt

Door hinges:

External dimensions, Width:

28 7/8" (734 mm)

External dimensions, Depth:

34 1/2" (877 mm)

External dimensions, Height:

43 1/4" (1098 mm)

Number and type of doors:

Number and type of grids

(included):

1 - Vinyl-Coated Steel

Type of external material:

Stainless Steel

Type of internal material:

Polystyrene

Warranty:

3 / 5 years

Refrigeration Data

Compressor power:

Refrigerant type:

R290

Operating temperature min.:

32 °F

Operating temperature max.:

41 °F

Condenser type:

Fin & tube

Defrost type:

Auto Defrost