

## Refrigerated bases Refrigerated Chef Base, 48 " (R290)

ITEM # \_\_\_\_\_  
MODEL # \_\_\_\_\_  
NAME # \_\_\_\_\_  
SIS # \_\_\_\_\_  
AIA # \_\_\_\_\_



738313 (KCHCB48R)

2-drawer chef refrigerated base, 48", R290 refrigerant gas, +33/+41°C, stainless steel

### Short Form Specification

#### Item No.

Refrigerated base with exterior back panel in stainless steel, bottom panel in galvanized steel, exterior side panels and top in 430 stainless steel; interior back panel in painted aluminium, interior bottom panels in 304 stainless steel and interior side panels in painted aluminium. Top in 430 stainless steel. Electronic Digital Temperature Control.

R290 gas in the refrigeration circuit.  
ETL Safety and Sanitation certified.  
3/5 Years warranty.

### Main Features

- External temperature display.
- Hydrocarbon refrigerant gas R290 for the lowest environmental impact (GWP=3) - CFC and HCFC free.
- High efficiency components to minimize the energy consumption still guaranteeing the highest performances.
- Cabinet and door insulated with high density polyurethane for low environmental impact.
- Recommended maximum temperature on worktop surface is 572°F.
- Insulation of the top guaranteed thanks to the Integrated ceramic fiber heat shield.

### Construction

- Pre-wired heavy duty power cord.

APPROVAL: \_\_\_\_\_

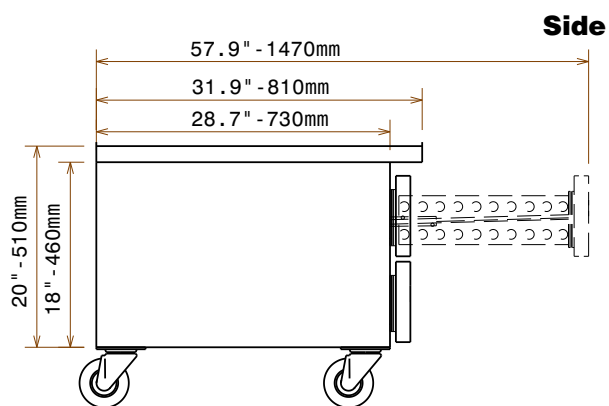
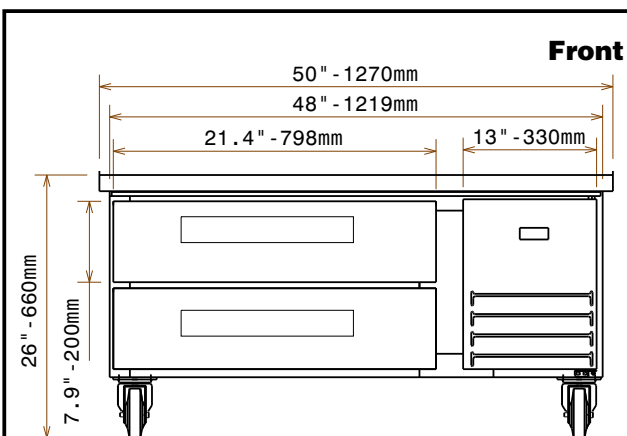

EI = Electrical connection

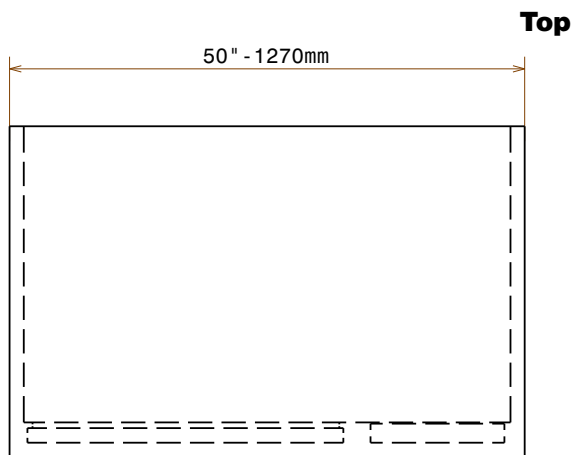

### Electric

#### Supply voltage:

738313 (KCHCB48R) 115 V/1 ph/60 Hz

#### Electrical power, max:

217.35 kW

#### Current consumption:

2.1 Amps

#### Total Watts:

217.35 kW

#### Plug type:

### Key Information:

External dimensions, Width: 50 " (1270 mm)

External dimensions, Depth: 31 7/8" (810 mm)

External dimensions, Height: 26 1/32" (661 mm)

#### Gross capacity:

Net weight: 234 lbs (106 kg)

Shipping width: (1300 mm)

Shipping depth: (835 mm)

Shipping height: (705 mm)

Shipping weight: lbs (118 kg)

Shipping volume: ft<sup>3</sup> (0.77 m<sup>3</sup>)

Refrigerant weight: lbs (90 g)

### Refrigeration Data

Refrigerant type: R290